

How to fit a Type 4 LNB or Quad LNB to the Boom Arm

The new type LNB's fit *around* the boom-arm, rather than inserted into it. The assembly is simple enough once you know how, and to assist, we have taken some pictures below:-



Place the edge of the LNB so that it rests under the edge of the protruding tab.

Move the LNB down so that the metal arm sits inside the plastic of the LNB (Note: the LNB will deform slightly, but this is normal)



The LNB will 'click' into place and you will see that the tidy tabs that poke out from each side of the underside of the LNB lock into equivalent cut-outs in the metal of the boom-arm, and the round holes also line up.

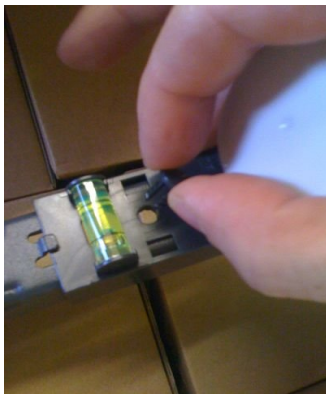

To finish, simply push the plastic insert (snap it off the LNB if it is still attached) into the hole.